

## Apple iOS

**Step 1. Download  App to your iPhone or iPad from the iTunes App Store.**

Enter “pal lighting” as your search term and touch on OPEN to install.



## Android OS

**Step 1. Download  App to your Android phone from the Google Play Store.**

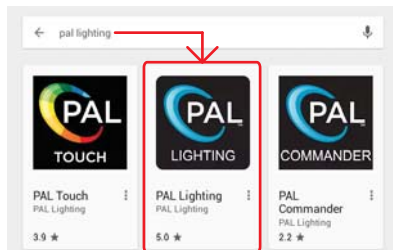

Enter “pal lighting” as your search term and touch on **INSTALL** to install the application.

**DO NOT** open the application yet.

**Step 2. Return to the Main Menu. Touch the  icon.**

This will take you to the Settings page.

### A. Select Wi-Fi

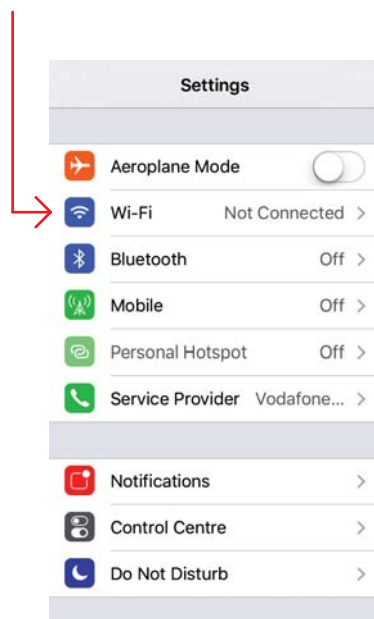

### B. Select 'PAL Lighting'



**Step 3. Return to the Main Menu. Touch  to open the application.**

3A



Loading Screen

3B



Press Refresh Button  
until Blue Tick appears  
Then Touch on Window

3C



Select TOUCH-5 to  
open the App

**Step 4. Operating the Touch-5 App.**

A. Select ON

4A



When "ON" is selected you can then control the color, brightness, mode & color change speed of your PAL Color Touch Light System as outlined in the adjacent instructions.

B. Select OFF

4B



To Power  
"OFF"

## Step 5. Channel Naming Procedure

5A



By pressing down the channel button you can detail the channel name.

5B



Type in selected channel name then select ok

5C



The channel name will appear.

Maximum number of characters that can be entered:  
iPhone 5/6 = 12 characters  
iPad = 10 characters



**COLOR WHEEL**

Can select any color from the color wheel.  
Can select Brightness (BRIGHT) on any selected color.

**OPERATIONAL LED**

Color selected is displayed here

**MODE SELECTION  
Up & Down**

1. White - Can change Brightness (BRIGHT) [Default]
2. Color Change - Can change Brightness (BRIGHT) & Speed (SPEED)  
Red, Amber, Green, Aqua, Blue, Purple, White  
with initial setting of 2 second delay.  
This time can be increased to 4, 6, 8 or 10 Sec  
by pressing (SPEED DOWN)
3. Disco - Can change Brightness (BRIGHT)
4. White Gradual Change - Can change Brightness (B) & Speed (S)
5. Blue Gradual Change - Can change Brightness (B) & Speed (S)
6. Green Gradual Change - Can change Brightness (B) & Speed (S)
7. Red Gradual Change - Can change Brightness (B) & Speed (S)

**4 CHANNEL  
ON/OFF  
BUTTONS**

**BRIGHTNESS  
Up & Down**

5 Brightness Settings  
(100%, 80%, 60%, 40%, 20%)

**SPEED  
Up & Down**

5 Speed Settings  
(2 sec, 4 sec, 6 sec, 8 sec, 10 sec)

**FEATURES**

1. Matching Code - Apply power to the receiver. Momentarily Press the Code Setting Button.  
Then press (UP) on Speed (SPEED) once within 2 seconds.  
The output light will flash white 5 times if matching is successful.
2. Clearing Code - Apply power to the receiver. Hold down (UP) on Speed (SPEED) for 5 seconds.  
The output light will flash 5 times if clearing the code is successful.  
After successfully clearing the existing code a new code will have to be applied  
by following the matching code procedure above.
3. 1 Transmitter (PCT-5) can operate an unlimited number of Receivers (PCR-4)
4. 1 Receiver (PCR-4) can be controlled by a maximum of 4 Transmitters (PCT-1) or (PCT-5)
5. Touching the color wheel will reset any Mode selection.
6. Memory Feature - Remembers color selection after being switched off.
7. Once the transmitter and receiver are successfully coded the receiver will remember the code if powered off.

1



Select Lock Mode

2



Select PAL Lighting

3

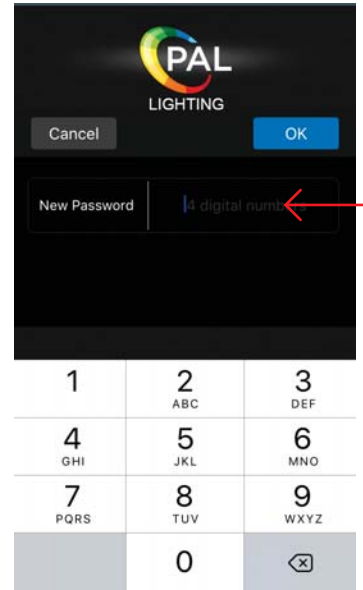

Enter a new 4 digit PIN  
and Select OK

4



Click here to  
Continue

5



The system is now  
locked and can be  
operated as normal

Additional

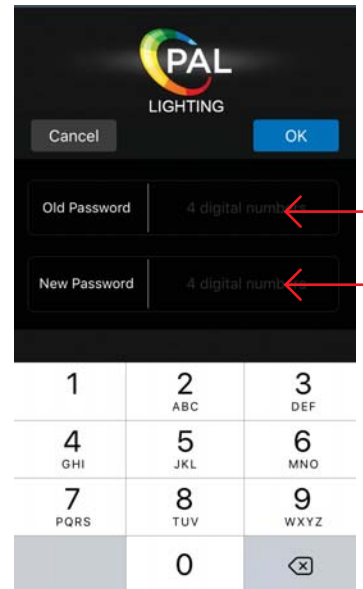

To change password  
later repeat steps 1 - 2  
and enter old PIN here  
and then insert a new PIN  
and Select OK

1



HOLD your finger on  
PAL Lighting

2



This screen will  
Display

3



Click here and  
Enter a new name

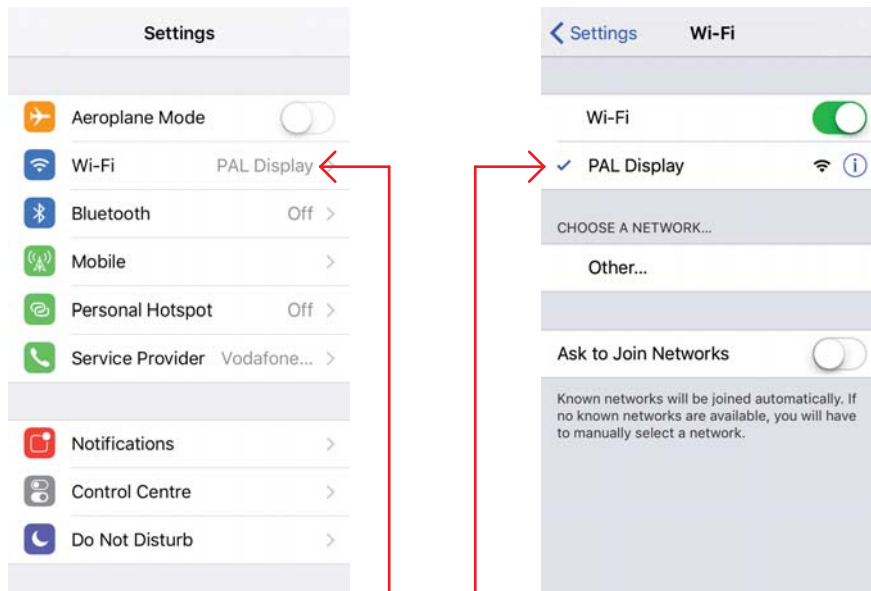

Your new name is now  
listed in Wi-Fi networks

1



Select 'Settings'

2

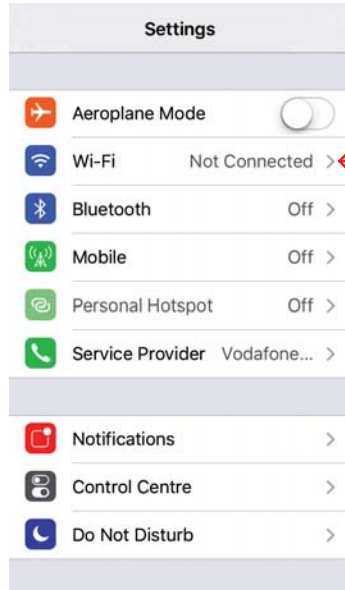

Select Wi-Fi

3



Select 'PAL Lighting'

4



Click on PAL Lighting  
The Blue Wi-Fi symbol  
indicates you are connected

5



Click on Settings Icon

6

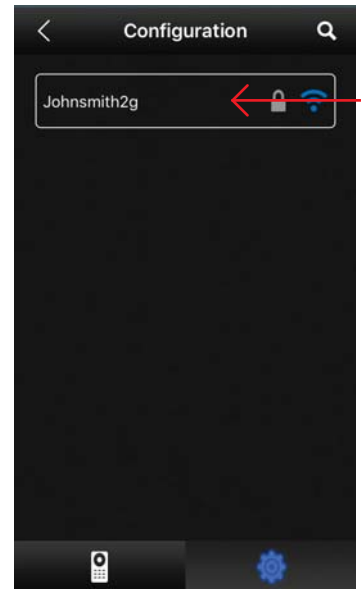

Select the name of  
your local Wi-Fi Network

7

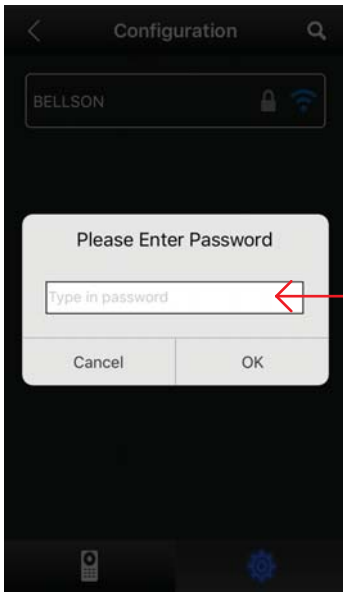

Enter local Network  
Wi-Fi Password and press OK

8

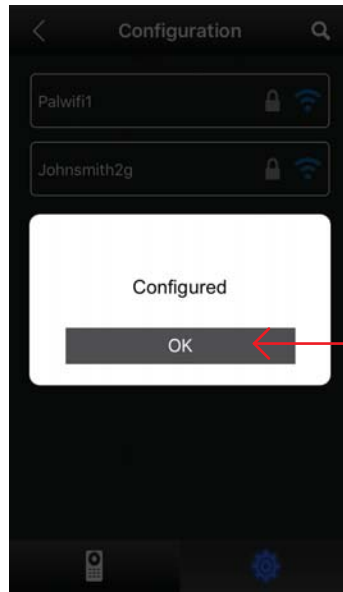

Wait for the Connection.  
When configured press OK.

9



Click here

10



The system is now  
connected to the local  
wi-fi router and can be  
operated as normal



1



You must be connected to your local router as per connecting to local router instructions

2

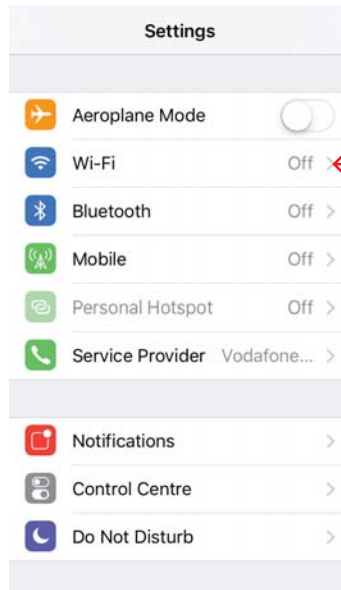

Turn off your Wi-Fi

3



Turn on your Mobile Data

4

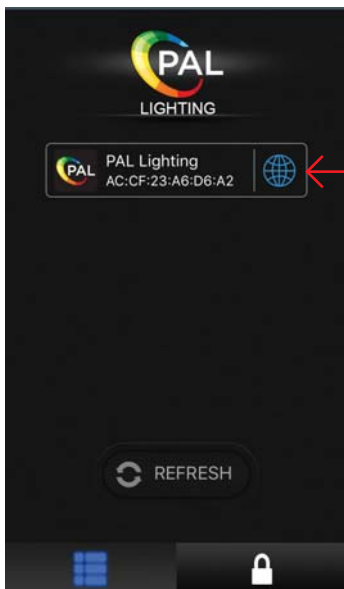

Open the app again and wait for the 'Global' symbol to appear. Click on 'PAL Lighting'

5



The system is now connected to the internet and can be operated as normal